

## POWDER ADHESIVE



POWDER ADHESIVE - In 1kg, 5Kg, 25Kg Bags  
instructions on packets, use straight from tub, slower settings

## READY MIXED ADHESIVE



READY MIXED ADHESIVE -  
1/2lt 1lr 2 1/2 5lt 10lt Tubs (7kg) (14kg) (35kg) (7kg) (14kg)  
instructions on tubs, use straight from tub, slower settings

## MITRE BLOCK UNIT

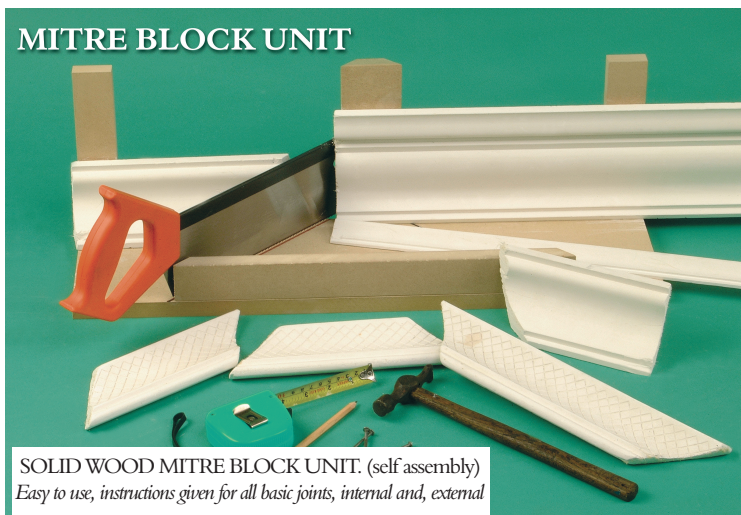

SOLID WOOD MITRE BLOCK UNIT. (self assembly)  
Easy to use, instructions given for all basic joints, internal and, external

## PLASTER FILLER



PLASTER FILLER - In 1kg, 5Kg, 25Kg Bags  
For plasterwork only, making good, filling joins and gaps. Very fast setting

## FIXING GUIDELINES ONLY – CASABELLA CORNICE & COVING

1

Buy the above casabella products to help and ease your way through in fixing ceiling roses, cornices & coving.



2 Measure the total length of coving required allowing additional 0.5m for each pair of mitres (corners, chimney breasts, reveals, etc)

3

Apply coving adhesive by 'buttering' top and bottom edges of the coving generously

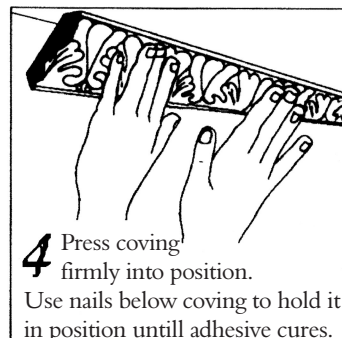
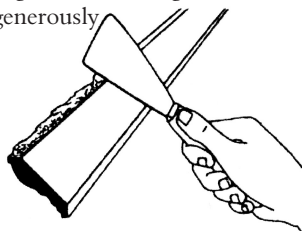

4 Press coving firmly into position. Use nails below coving to hold it in position until adhesive cures.

## CEILING ROSES – BASIC GUIDELINES ONLY - PLEASE ASK FOR MORE DETAILED INFORMATION

1 Measure and pre-drill ceiling rose

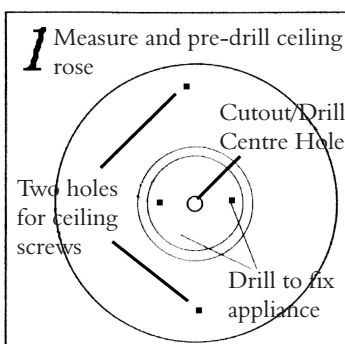

2 Drill the centre hole for electricity supply and two holes to take screws into ceiling joist

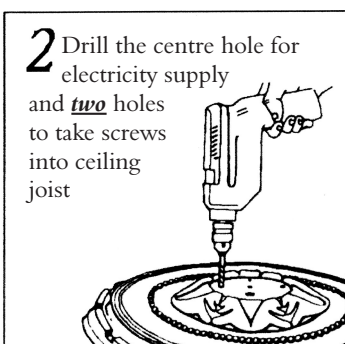

3 Spread coving adhesive on the reverse of the rose. Press firmly into position and tighten screws into ceiling.

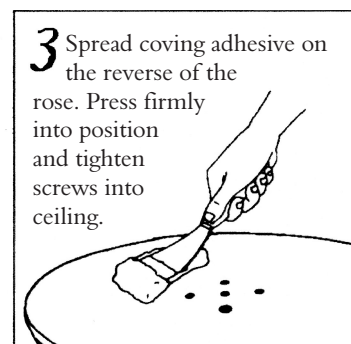

4 Once rose is secured, draw cable through centre hole and use remaining two holes for fixing appliance.

